

Canon

Delighting You Always



imageRUNNER
ADVANCE

C5035/C5030

Advanced Design for
Advanced Performance



Advanced Design for Advanced

Moving into a new decade with keener competition, businesses are looking for a more powerful multifunctional device that can do higher quality work in less time and easier way. The new imageRUNNER ADVANCE C5035/C5030 are designed to meet the rigid requirements of any workgroups, offices, departments, or even the whole business.

Featuring a sleek body, this state-of-the-art imageRUNNER ADVANCE series is built to ease your document workflows and enhance business communication so that you can enhance productivity with remarkably high quality. Also, realizing the importance of security and green consciousness, this new series can safeguard your confidential information and providing a greener environment with reduced CO₂ emission and enhanced energy efficiency.

With a wide versatility of advanced features in printing, copying, sending, storage and connectivity, the new imageRUNNER ADVANCE C5035/C5030 are ideal devices for multitasking and complicated working environments. You are able to streamline your jobs in one operation and accomplish outstanding multitasking performance with no hassle.

Canon imageRUNNER ADVANCE is your truly advanced partner for deploying a truly digital office.

Productivity

Security

Efficiency

Cost Control

Document Sharing & Storage

Device Management

Usability

Environmental Friendly

Performance



imageRUNNER
ADVANCE

C5035/C5030

imageRUNNER ADVANCE C5035

- Color 35 ppm
- Black & White 35 ppm

imageRUNNER ADVANCE C5030

- Color 30 ppm
- Black & White 30 ppm

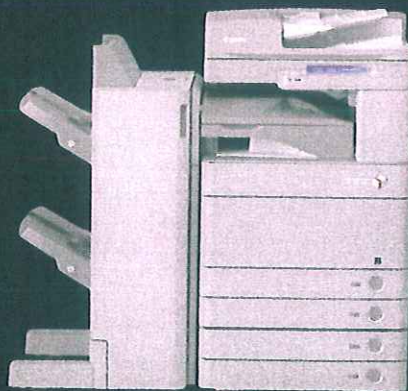

Copy / Print / Scan & Send / Fax / Scan & Store



1200 x 1200 dpi print resolution

Outstanding configurations

- Advanced imageCHIP system architecture
- Standard with 80GB HDD, 2GB RAM
- Compact Design

Impressive productivity

- Up to 35/30 ppm printing speed (Black-and-White/Color, A4)
- Up to 100 ipm single pass duplex scanning (Black-and-White/Color, A4 at 300dpi)
- Warm-up time only 38 seconds from power ON

Enhanced collaboration

- Advanced Box document sharing solution
- Standard with Universal Send
- Adobe® PDF formats
- Scan to and print from USB thumb drive / memory cards

Strong environmental consciousness

- 1W power consumption during Sleep Mode
- ENERGY STAR qualified
- Applying higher standard than EU RoHS Directive
- Reducing CO₂ emissions significantly
- Noise reduction design



Remarkable Performance

Enhanced Scanning Quality and Speed

imageRUNNER ADVANCE C5035 / C5030 utilize Canon's proprietary image sensor to improve both image quality and scanning speed.



• PQ Toner

Delivering Professional Printing Quality

imageRUNNER ADVANCE C5035 / C5030 inherit many innovations from Canon digital systems used in professional printing companies, which include a new pQ toner, durable E-Drum (B/W), and a sophisticated controller that delivers vivid color prints with high fidelity.



• Canon's Proprietary Image Sensor

Enabling Multitasking Performance

With imageRUNNER ADVANCE C5035/C5030, users can accomplish multiple tasks concurrently with a very high speed that meets your rigid requirements. These imageRUNNER ADVANCE devices incorporate Canon's cutting edge Advanced imageCHIP system architecture, which features two processors to deliver outstanding multitasking performance.

The embedded image processing board works with the scanner, adjusts image size, and ensures superior image quality and super-fast processing. Also, the information processing board controls the user interface and coordinates device networking and connectivity.



• Advanced System Architecture

On Demand Fixing Unit for High Energy Efficiency

The use of On Demand Fixing unit ensures better reliability than with conventional rollers, which results in reduced downtime.

Compared to the 4 minutes of the conventional model, the warm-up time of the imageRUNNER ADVANCE C5035/C5030 has been drastically shortened to 38 seconds. Energy efficiency also has been significantly improved.

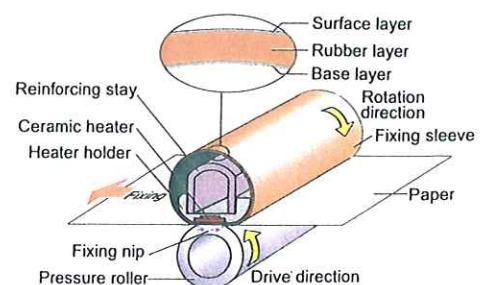

• On Demand Fixing Unit



Configurations

Various finishing options

- Stapling
 - Corner / Double
 - Booklet-making
- Hole-punching
- Inner finisher for space saving

Outstanding paper handling

- Up to 5,000-sheet paper capacity
- Support 52 – 256 g/m² paper weight
- Up to 320 x 457mm media size
- Tab / Envelope Feeding option available



High speed scanning

- Canon's proprietary image sensor
- Up to 100 ipm single pass duplex scanning speed (Black-and-White / Color, A4 at 300dpi)

Reliable consumables and supplies

- Durable E-drum (B/W) and OPC drum (Color)
- Replace toner without stop printing
- Newly developed pQ Toner

Finishing Options

Staple Finisher-C1



Booklet Finisher-C1



Inner Finisher-A1



External 2 Hole Puncher-B1

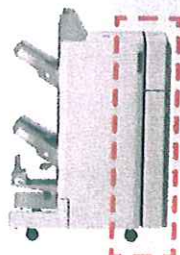

Paper Handling Options

Cassette Feeding Unit-AD1

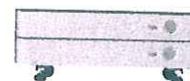

Paper Deck Unit-B1



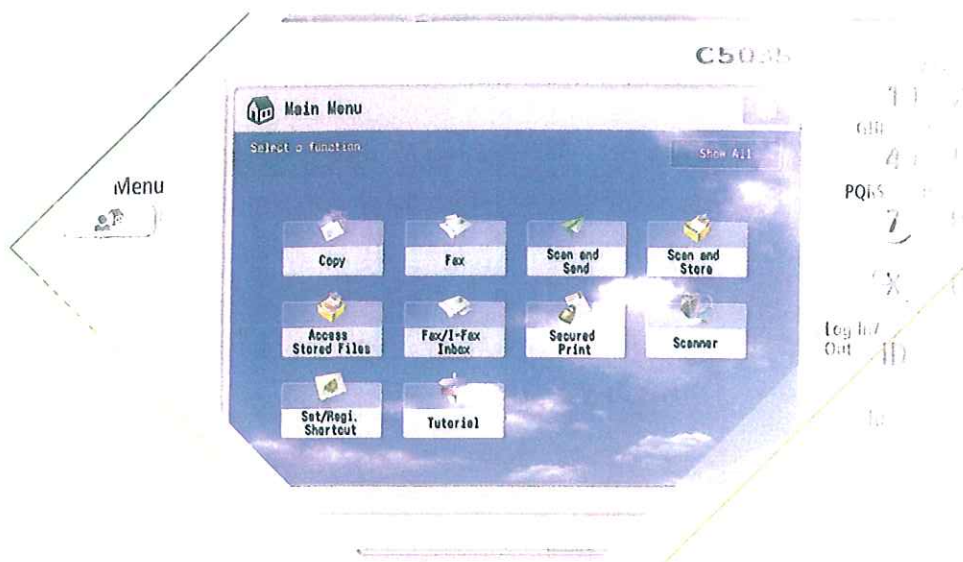

Smart Usability

Enhancing Workflow with Customizable User Interface

Users can customize screen options for individuals when authentication login is enabled. Users can personalize and speed-up access to the most relevant functions for their specific role through setting their own buttons, combining and accessing routine tasks at the touch of just one button in Quick Menu.

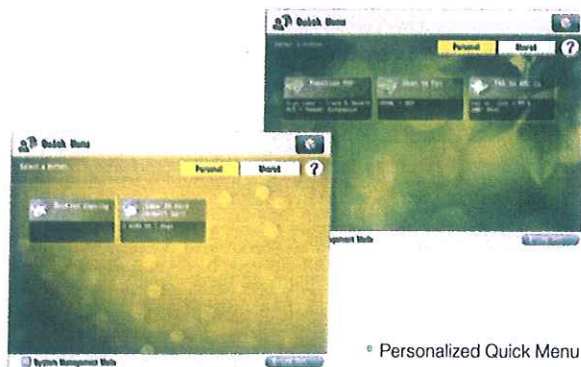

• Personalized Quick Menu

Facilitating Operation by Slide-and-tilt LCD Control Panel

The imageRUNNER ADVANCE C5035 / C5030 feature a large 8.4" and high-quality color SVGA TFT LCD touch screen user interface, which can organize the onscreen buttons to fit the way they work by determining their number, size and layout.

The new devices come with a new "slide-and-tilt" feature to allow users to adjust the control panel to a comfortable and accessible position.

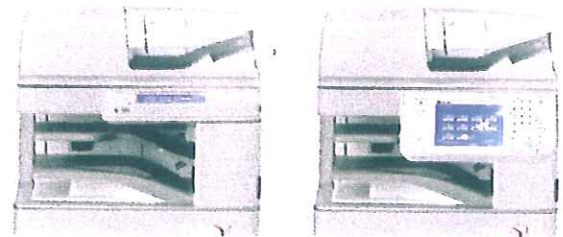

• Slide-and-tilt Control Panel

Getting a Wide Range of Connectivity Options

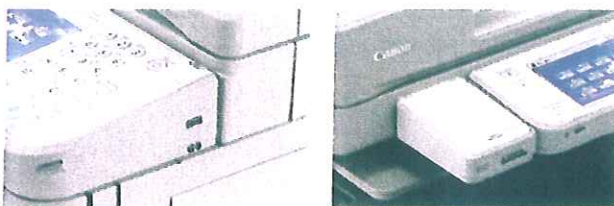

• Support USB thumb drive and memory media connectivity

Designed to offer easier document work, users can scan to and print from a USB thumb drive directly. Also, versatile memory media, such as SD cards, Memory Sticks or CompactFlash cards, can also be connected without a PC. An optional keyboard may also be attached for easier and more comfortable typing.



Green Consciousness

Minimizing Noise Levels

Various noise-reducing measures and control features are implemented in the configuration of the imageRUNNER ADVANCE C5035/C5030 to ensure minimum noise levels during both operation and standby mode.

Conforming to RoHS Standard

Canon exceeds the toughest global standards set by the EU RoHS standard, which requires the restriction of six specified hazardous substances. Canon currently restricts the use of 24 such substances.

Constructed with Eco-Friendly Materials

Paying close attention to environmental protection, all imageRUNNER ADVANCE devices are constructed with eco-friendly materials. They employ certain components fabricated with 100% recycled plastic materials from retired products. Canon's innovative green technologies also include bio-based plastic materials, and a plant-derived compound that replaces certain petroleum-based plastic parts.

Lowering CO₂ Emissions

Canon has lowered CO₂ emissions by focusing on each stage of the product life cycle, including manufacturing, energy use, and logistics by 30% compared with conventional model.

Enhancing Energy Efficiency

The imageRUNNER ADVANCE Series is designed for high energy efficiency and extraordinary performance. The combination of Canon's On Demand Fixing technologies and the new pQ toner significantly reduces overall energy consumption by minimizing heat and power requirements. When devices are in Sleep Mode, power consumption is only 1W or less.



• Bio-plastics



Advanced Document Sharing and Collaboration

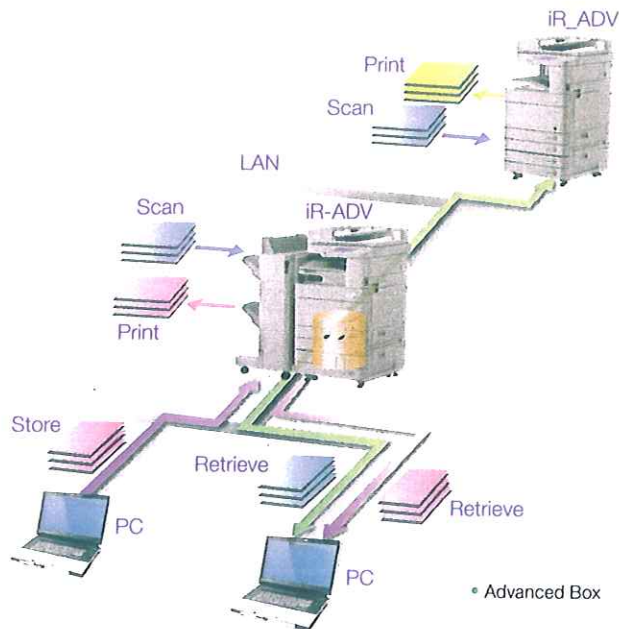

Upholding Seamless File Sharing

imageRUNNER ADVANCE C5035 / C5030 provide Advanced Box, which utilizes dedicated hard disk space on the device for file sharing over SMB and WebDAV connections. Once files have been stored in Advanced Box, users can access these files from PCs and other imageRUNNER ADVANCE systems running on the network.

Supporting Versatile File Formats

The Advanced Box supports a wide variety of file formats so that documents created on PCs can be saved as its original format in Advanced Box, including Word, Excel, PowerPoint, PDF, etc.

Print Options

Supporting Multiple PDLs and Protocols

imageRUNNER ADVANCE C5035 / C5030 supports multiple PDLs (Page Description Language) and multiple protocols to accommodate varying office network environments. Supported PDLs include Canon's proprietary high-speed UFR II, PCL and Adobe® PostScript® 3™ for specific production needs. As a result, users can benefit from versatile printing solutions.

Encouraging Creativity for Better Performance

The devices come with an optional controller, imagePASS-B1. Also, it is built with Adobe® PostScript® 3™ printing technology that supports advanced workflow and color management capabilities. They support a wide range of protocols and fit in various network environments.

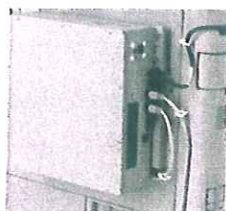

• imagePASS-B1



Copy Performance

Making Copy Settings User Friendly

The Regular Copy Basic Features Screen displays preview images in the upper right area for users to confirm the currently specified settings, such as "2-Sided" and "N on 1" in a quick glance. Also, you can register frequently used settings in memory. This further enhances your workflow efficiency.

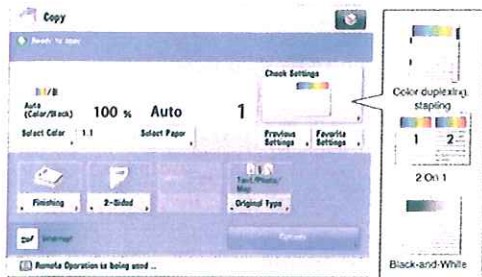

• Copy settings at a glance



Security Solutions

Canon has introduced advanced security related features to strengthen Device Security, Data Protection and Information Integrity.

Document Security

- Document Scan Lock
- Adobe® LiveCycle® Rights Management ES
- Encrypted Secure Print
- Watermark/Secure Watermark
- Copy Set Numbering
- Encrypted PDF
- Digital Signature PDF
- Fax Forwarding
- Fax Destination Confirmation

Mail Server Security

- POP Authentication before SMTP
- SMTP Authentication

Network Security

- IP/MAC Address Filtering
- SSL Encryption
- Network Application On/Off
- USB Port On/Off
- Destination Restriction
- IP Sec
- IEEE 802.1 x (Wire / Wireless)

Data Security

- Trusted Platform Module
- HDD Data Erase
- HDD Data Encryption
- Advanced Box Security
- Mail Box Password Protection
- Removable Hard Disk Drive

Authentication

- Department ID / Control Card Systems
- Device Level Login (SSO-H)
- Access Management Systems (AMS)
- Function Level Login via AMS

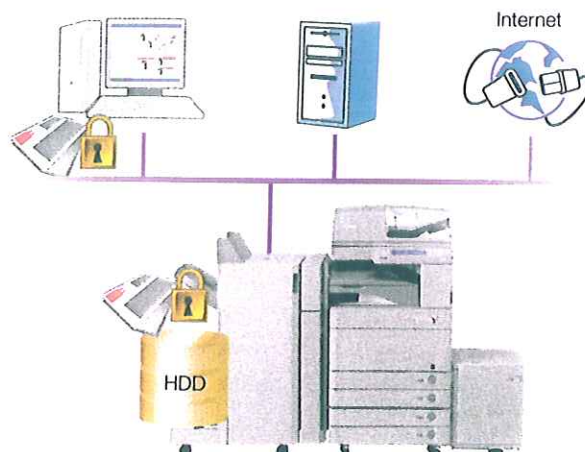

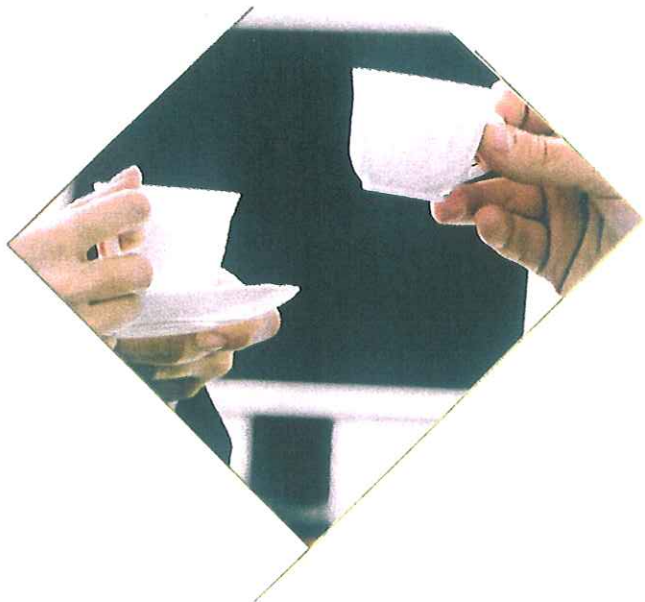

Smart Communication and

Offering a Rich Array of File Formats through Scanning

The new imageRUNNER ADVANCE Series meets demanding office requirements of a wide range of file formats in scanning. Many new file formats have been added and the devices can generate a variety of Adobe PDF formats through scanning.



Simplifying Workflow in One Operation by Universal Send

Universal Send enables users to scan hard-copy originals, convert them into digital documents, and push them to multiple destinations in one operation. With this feature, image files can be sent to any network destination including E-mail addresses, file folders, Fax and I-Fax numbers. This helps users improve their digital document distribution workflow.

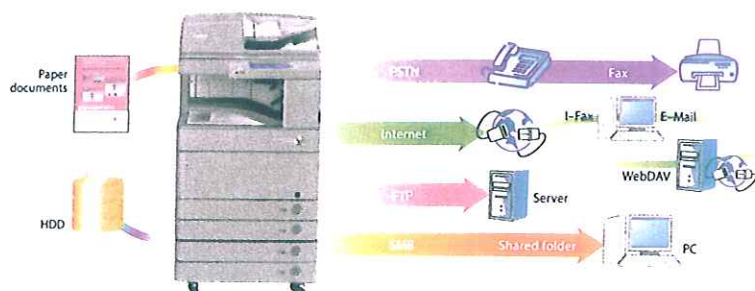

File Formats Supported

- | | |
|--|--|
| ✓ Tiff | ✓ JPEG |
| ✓ PDF | ✓ Office Open XML (OOXML) |
| <ul style="list-style-type: none"> • PDF • High Compression • Searchable PDF • Encrypted PDF • Trace & Smooth PDF • Digital Signature • PDF/A-1b • Optimize PDF for Web PDF • Reader Extensions PDF • Policy-protected PDF | <ul style="list-style-type: none"> • Office Open XML (OOXML) • Searchable OOXML |
| | ✓ XPS |
| | <ul style="list-style-type: none"> • XPS • High Compression XPS • Searchable XPS • Digital Signature XPS |

Effective Management for Lower TCO

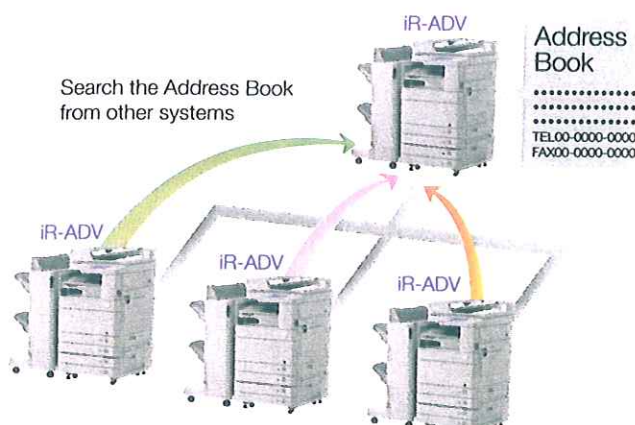

Implementing Centralized Management with Address Book Sharing

By registering shared destinations in the Address Book of one imageRUNNER ADVANCE device, users can access that Address Book to select sending destinations from other imageRUNNER ADVANCE devices on the network. This reduces the effort of registering the same destinations on multiple systems and facilitates centralized management.



Document Distribution

- **Supporting Adobe LifeCycle® Rights Management ES**

The imageRUNNER ADVANCE C5035 / C5030 support Adobe LifeCycle® Rights Management ES functionality via a user-installed rights management server. Users can thus assign fully editable usage rights, such as reviewing, copying, editing, or printing, to policy protected PDF files. Rights can be modified for all rights-protected files after distribution.

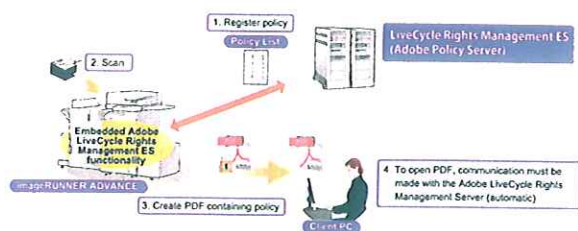

• Adobe LifeCycle® Rights Management Outline

- **Boosting Color Document Distribution by High Compression PDF**

The imageRUNNER ADVANCE C5035 / C5030 come standard with High Compression PDF creating function, which is a Canon's proprietary document conversation technology that allows users to compress an image file into 1/10 of the original size. Hence, it reduces network burden when sending color documents, thus making smooth and easy network transfer.

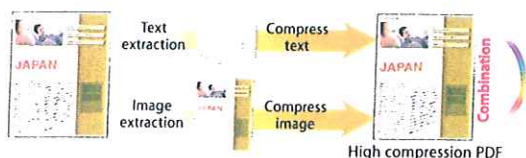

- **Scanning Paper Documents to PowerPoint (Office Open XML) without Hassle**

Office Open XML is Microsoft's new and native fully-editable file format, which has been the default file format of Microsoft Office 2007 onwards. The imageRUNNER ADVANCE series supports the PowerPoint .pptx file format. Users can scan paper documents into PowerPoint files (.pptx) directly and edit logos, images or text to create new presentation files.



• Scan to PowerPoint

- **Enhancing Reader Extensions in Adobe Reader**

The imageRUNNER ADVANCE series can add Reader Extensions to PDF files, enabling users' usage rights such as filling out, marking up, saving and annotating in Adobe Reader version 7.0 or higher.

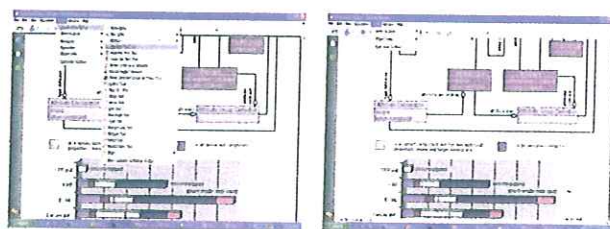

• With Reader Extensions

• Without Reader Extensions

Multi-Line Fax Support

The imageRUNNER ADVANCE C5035 / C5030 support up to four fax lines to accommodate users who need multiple lines for high volume fax usage. Combined with the use of Remote Fax, it provides a scalable fax solution.

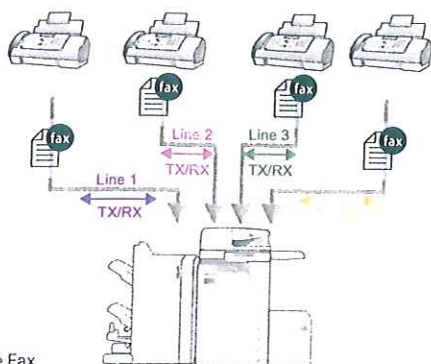

• Multi-Line Fax

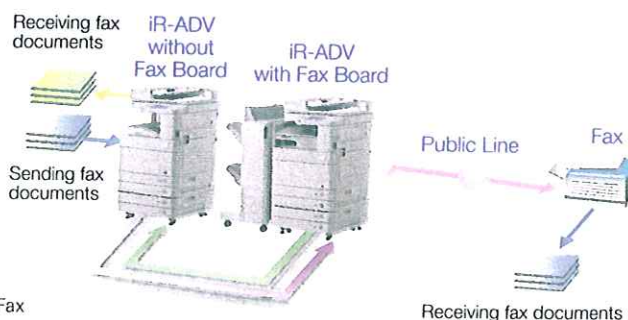

• Remote Fax

Achieving Remote Fax via One Host Device

Utilizing a fax-enabled imageRUNNER ADVANCE device as the fax server, other imageRUNNER ADVANCE devices without fax line can send and receive fax documents via the host device. This expedites business processes and reduces the expense of extra fax line.



◀ Introduction	01 - 02
◀ Remarkable Performance	03
◀ Configurations	04
◀ Smart Usability	05
◀ Green Consciousness	06
◀ Advanced Document Sharing and Collaboration	07
◀ Print Options	07
◀ Copy Performance	08
◀ Security Solutions	08
◀ Smart Communication and Document Distribution	09 - 10
◀ Effective Management for Lower TCO	09 - 10





imageRUNNER
ADVANCE

C5035/C5030

